

FOR SALE

3206 BLOOMINGTON AVE
MINNEAPOLIS, MN 55407



8,900 SF Industrial Building



COMMERCIAL REAL ESTATE SERVICES

Scott Kragness *Senior Sales Executive*

1950 Northwestern Ave N #101
Stillwater, MN 55082

Cell 651.323.8454
Office 651.351.5005

Email Scott@MetroEastCRE.com
Web www.MetroEastCRE.com

FOR SALE: Industrial Building

3206 Bloomington Ave | Minneapolis, MN 55407



Property Information

Building Size:	8,900 SF Total 7,900 SF Heated Warehouse 1,000 SF Office/Showroom
Site Size:	0.36 acres
Loading:	One (1) Dock Door Two (2) Drive-in Doors
Asking Rate:	Negotiable
2025 Proposed Taxes:	\$19,983.82
Year Built:	1958
Parking:	Surface Lot
Features:	<ul style="list-style-type: none">◆ Fenced Outdoor Storage◆ Highly visible



COMMERCIAL REAL ESTATE SERVICES

Scott Kragness Senior Sales Executive

1950 Northwestern Ave N #101
Stillwater, MN 55082

Cell 651.323.8454
Office 651.351.5005

Email Scott@MetroEastCRE.com
Web www.MetroEastCRE.com

The information contained herein has been provided by the property owner or obtained from sources deemed reliable. Although the information is believed to be accurate, it is not guaranteed. The property is subject to price change, prior sale or lease and withdrawal from the market, without notice. Buyer is responsible to conduct its own due diligence, as this offering contains no representations or warranties.

FOR SALE: Industrial Building

3206 Bloomington Ave | Minneapolis, MN 55407



COMMERCIAL REAL ESTATE SERVICES

Scott Kragness Senior Sales Executive

1950 Northwestern Ave N #101
Stillwater, MN 55082

Cell 651.323.8454
Office 651.351.5005

Email Scott@MetroEastCRE.com
Web www.MetroEastCRE.com

The information contained herein has been provided by the property owner or obtained from sources deemed reliable. Although the information is believed to be accurate, it is not guaranteed. The property is subject to price change, prior sale or lease and withdrawal from the market, without notice. Buyer is responsible to conduct its own due diligence, as this offering contains no representations or warranties.

FOR SALE: Industrial Building

3206 Bloomington Ave | Minneapolis, MN 55407

Available Space

8,900 SF*

* All square footages assumed to be approximate - Floor Plan is not to scale

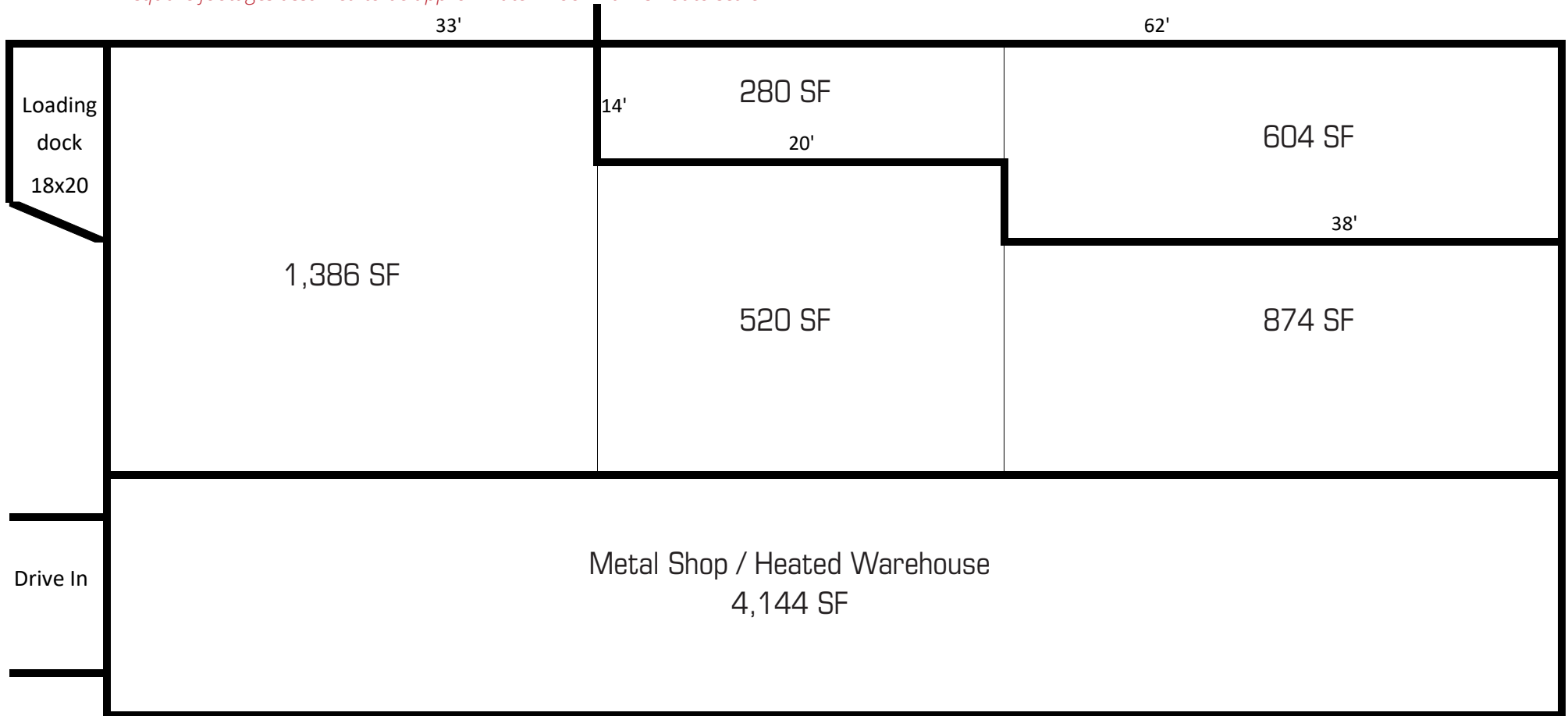

COMMERCIAL REAL ESTATE SERVICES

Scott Kragness Senior Sales Executive

1950 Northwestern Ave N #101
Stillwater, MN 55082

Cell 651.323.8454
Office 651.351.5005

Email Scott@MetroEastCRE.com
Web www.MetroEastCRE.com

The information contained herein has been provided by the property owner or obtained from sources deemed reliable. Although the information is believed to be accurate, it is not guaranteed. The property is subject to price change, prior sale or lease and withdrawal from the market, without notice. Buyer is responsible to conduct its own due diligence, as this offering contains no representations or warranties.

FOR SALE: Industrial Building

3206 Bloomington Ave | Minneapolis, MN 55407

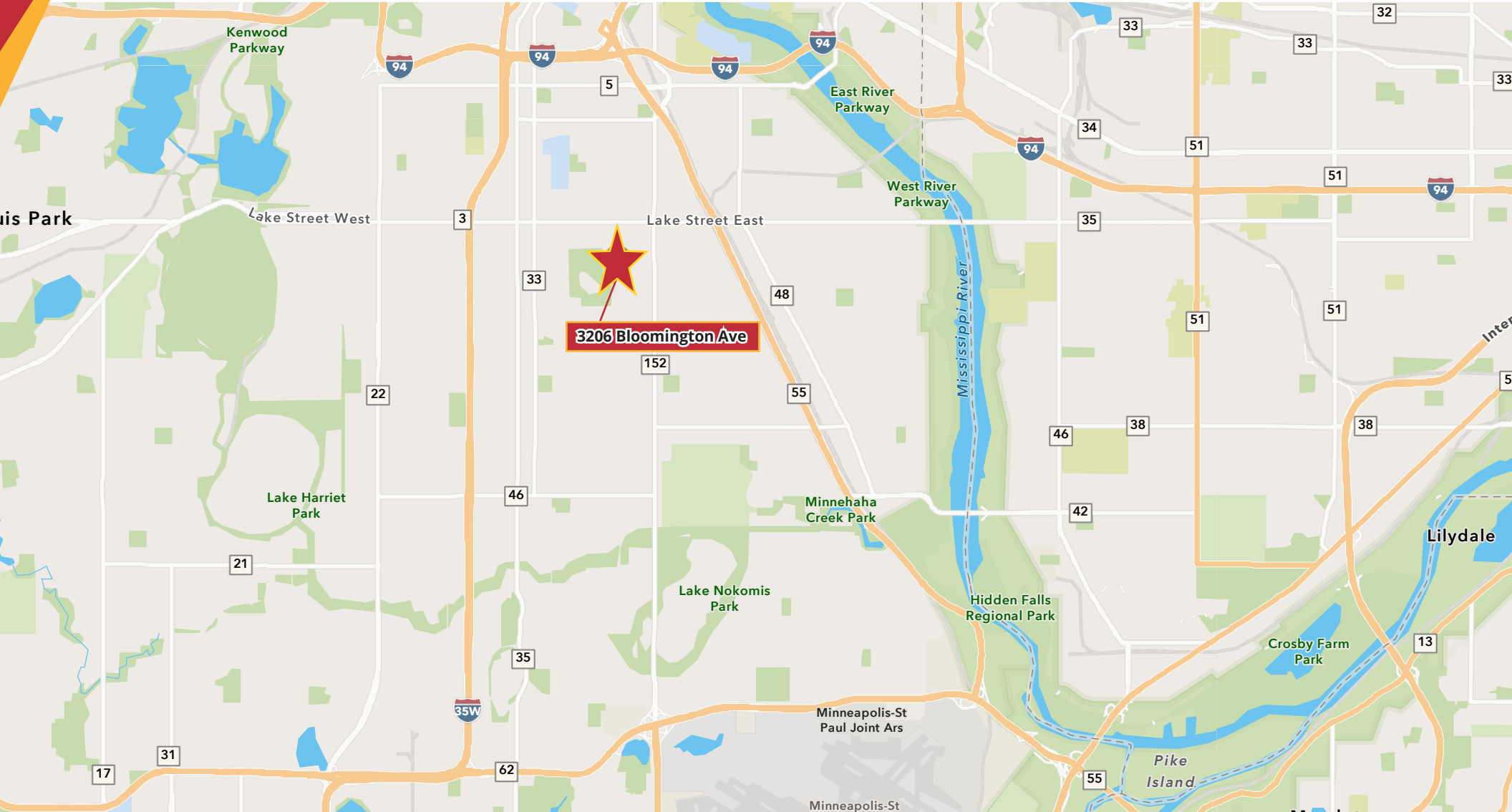

COMMERCIAL REAL ESTATE SERVICES

Scott Kragness Senior Sales Executive

1950 Northwestern Ave N #101
Stillwater, MN 55082

Cell 651.323.8454
Office 651.351.5005

Email Scott@MetroEastCRE.com
Web www.MetroEastCRE.com

The information contained herein has been provided by the property owner or obtained from sources deemed reliable. Although the information is believed to be accurate, it is not guaranteed. The property is subject to price change, prior sale or lease and withdrawal from the market, without notice. Buyer is responsible to conduct its own due diligence, as this offering contains no representations or warranties.